

Weld-in resistance thermometers with thermowell 24 mm dia.

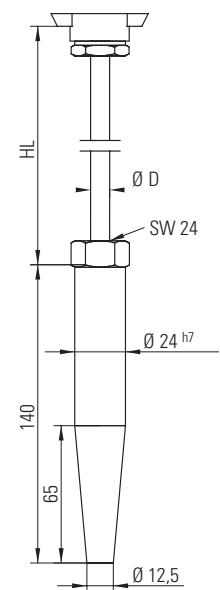

Weld-in resistance thermometers acc. to DIN 43772

- for insertion in solid, liquid or gaseous media
- especially suitable for overpressure applications
- moderate variable installation length
- for high mechanical and thermal loads
- with weld-in protective stainless steel sheath 1.4571
- cable entry of connecting head alignable

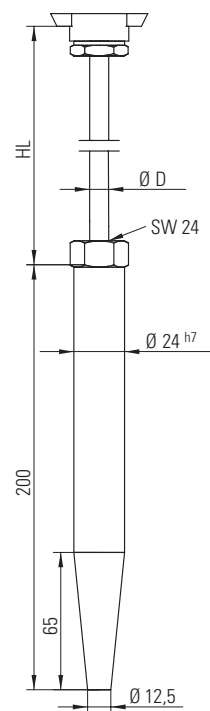
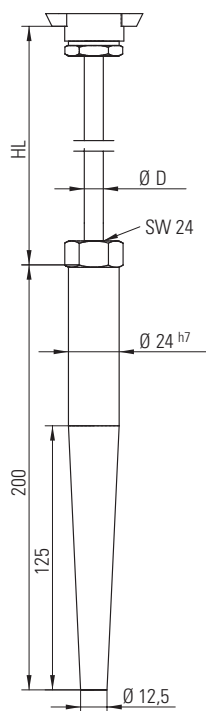
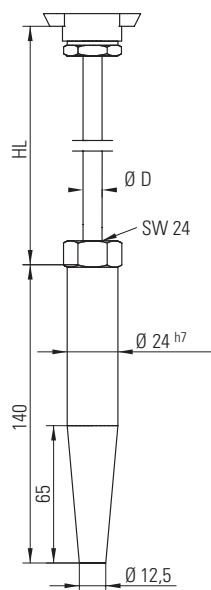

Type	WT-BD-D1	WT-BD-D2	WT-BD-D4	WT-BD-D5
Design acc. to DIN 43772	Form 4			
Fixation	Welding			
Diameter of thermowell D (mm)	24 ^{h7}			
Insertion length (mm)	140	200	200	260
Lagging tube length HL (mm)	165			
Operating temperature (°C)	-60 to +500			
Connection head (acc. to DIN)	Form B			
Connection	Ceramic block with bush terminals			
Sensor type and wire connection	Pt 100 for 2-, 3- or 4-wire connection; single or twin			
Accuracy class (acc. to DIN EN 60751)	B			
Measuring insert	Changeable			
Accessories	Weld-in thermowells			

Besides the standard versions shown on this page we can also supply specials (dimensions, connection heads, head transmitters, sensors, accuracy classes, vibration resistance, materials, DKD certificates, etc.)

Weld-in resistance thermometers with thermowell 30 mm dia.



Weld-in resistance thermometers acc. to DIN 43772

- for insertion in solid, liquid or gaseous media
- especially suitable for overpressure applications
- moderate variable installation length
- for high mechanical and thermal loads
- with weld-in protective stainless steel sheath 1.457
- cable entry of connecting head alignable

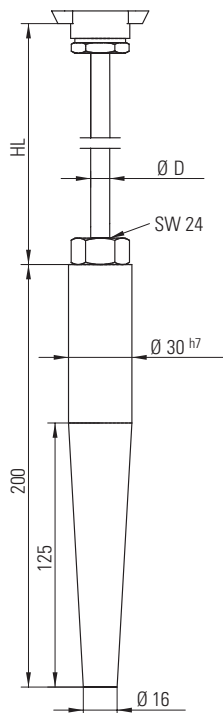

WT-BD-D3

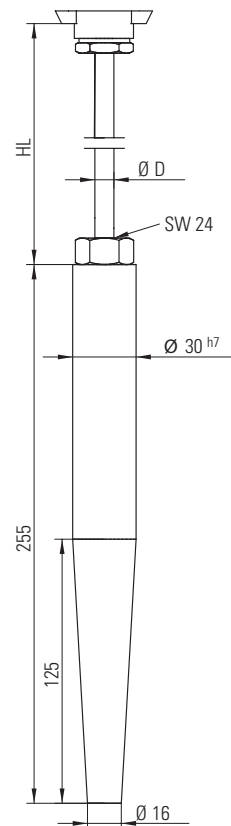

WT-BD-D6

Type		Similar to Form 4
Design acc. to DIN 43772		Welding
Fixation		30 ^{h7}
Diameter of thermowell D (mm)		255
Insertion length (mm)	200	165
Lagging tube length HL (mm)		-60 to +500
Operating temperature (°C)		Form B
Connection head (acc. to DIN)		Ceramic block with bush terminals
Connection		Pt 100 for 2-, 3- or 4-wire connection; single or twin
Sensor type and wire connection		B
Accuracy class (acc. to DIN EN 60751)		Changeable
Measuring insert		Weld-in thermowells
Accessories		

Besides the standard versions shown on this page we can also supply specials (dimensions, connection heads, head transmitters, sensors, accuracy classes, vibration resistance, materials, DKD certificates, etc.)